



Call- +91-8750620008

Member
CREDIT





The image above is an artistic rendering of a spiral staircase.

ATI Homes are known for their high green ratings, modern architecture, chic amenities and a host of other innovative features. After delivering several world-class projects, ATI has launched, within a short span of time, a name in realty with in the real estate sector in India. The company has chosen a niche for itself in the real estate development, setting unprecedented standards in architecture, design and aesthetics.

ATI has witnessed a phenomenal growth with nearly 2.5 million sq. mt. of residential space already delivered, 10 million sq. mt. under progress, with in-house construction, security, facility and maintenance teams and unmatched brand equity.



THE PHOTOGRAPHY IS BY MICHELLE PERIN. STYLING: JESSICA GARDNER FOR STYLING



HomeBlink, like 55 Ltd, is the new housing venture of 420 Group, positioned in other operational forms of sustainable value. HomeBlink has garnered significant attention of the real estate sector with its new concept in the realm of aspirational housing.

After delivering the most sought after real estate projects, HomeBlink, from 55L, introduces a new dimension to the Indian quality housing arena - Happy Trails. Dedicated to urban housing, this arena will be "from market" forward. Happy Trails redefines the idea of modern homes in India. An innovation in housing, Happy Trails gives you the edge of owning the most futuristic homes at affordable tags.



The image shown is for illustrative purposes only and is not to scale.

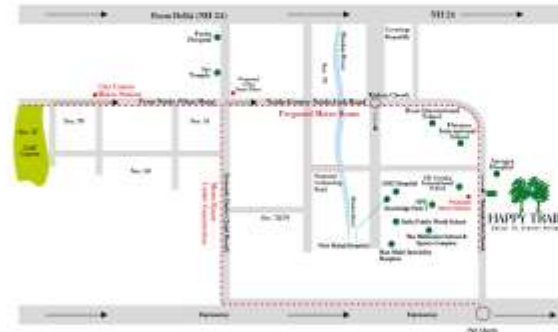

Map not to scale

The address you've always wanted

- Sector 22, Greater Noida (UP)
- On the State Queen Road Link Road
- 20 minutes drive to RTI 24
- 30 minutes from Noida City Centre
- 5 minutes drive to Buzak Chowk
- Proximity schools, shopping centres in the vicinity
- Next to upcoming metro station

What's at the heart of it?

Happy Trails seeks to make aspirational housing the order of the day. The attractive and lush amenities notwithstanding, Happy Trails residences bring the happiness of quality living one step closer to the home seekers who also want value for their money. There is, of course, the luxury of space and spectacular greens to add to the charm of living in utmost serenity. Happy Trails introduces newest and unprecedented features in homes, which are created to define the new-age quality housing in India. Featuring a contemporary architecture, these homes have been crafted for supreme locations, in sync with the latest innovations in the realm of quality living. Every

Happy Trails residence has the quintessential A55-style charm to it, with an aura of a truly perfect home.



Photo: Home by HOMEPUR & CO. only with a custom design



The image shows a large swimming pool in a modern apartment complex.



The image shows a balcony with a wooden chair, a table, and potted plants.



THE HAPPY TRAILS IS AN AFFORDABLE LUXURY HOUSING PROJECT IN GURGAON

Happy Trails – home to ideal things in life

Gurgaon, Noida (W) Sector 82 is home to a new wave of stunning towers, right in Noida-Gurgaon, Noida Link Road and it's set to catch the eye of every home seeker. The exclusive Happy Trails, enclosed in the courtyard of these 12 towers, is strategically positioned to give each home owner an eternal scenic panorama from his balcony. The residences come in 2, 3 & 3+bedroom apartments, ranging from 800-820 sq. ft. spaces, with most of the apartments facing either the Club or the Green Belt. The spaces come with diverse features and amenities with outstanding facilities.





PHOTOGRAPH BY MICHELLE BROWN FOR HOMES & HONEY



PHOTOGRAPH BY MICHELLE BROWN FOR HOMES & HONEY

Amenities that touch your heart

Owning a home at Happy Trails comes with huge value for money. The premium towers give you the luxury of having only 2 apartments per floor, with each measuring 1225 sq. ft., giving you freedom and space to live the life you have always wanted. The residences feature a central clubhouse, swimming pool, tennis court and green landscaping. The Club facilities include indoor squash court, multi-purpose hall, card room, indoor gymnasium, swimming pool, kids swimming pool, etc.





What's more?

With ultra-chic amenities and unprecedented sports facilities, Happy Trails promises to bring complete entertainment packages right at your door. Few campus level amenities include badminton and basketball court, tennis court, jogging track, skating rink, amphitheatre, kid's play area that houses designated space for hide 'n' seek, etc.

There will be no vehicular movement on podium level, with children and senior citizens having direct access to it. Special plants will be raised across the campus to help reduce the



pollution in immediate vicinity. So, come and explore the unique Happy Trails experience that promises to make an indelible impression.



Site Plan



Disclaimer: The Site Plan shown is tentative. The overall layout may vary because of mandatory design reasons.



Architect
Hafeec
Contractor

Type A - Typical Floor Unit



- Note:
1. The window profile location & sizes may change because of structural reasons.
 2. The ground layout may vary because of statutory reasons in case required.
 3. Column location for stack shaft only as per structure.
 4. Layout shown is for illustrative purposes, for specific unit floor plan please contact sales.
 5. Selective area is tentative and is subject to change due to modifications asked for by approving authorities from time to time till occupancy certificate is obtained. Architects reserves the right to accommodate any design specifications/structural provisions.

Isometric View



The image shown here is non-illustrative and not to be added to contract.

Type B - Typical Floor Unit



Seivable Area: 2607 sq. mt.
 30.00 sq. mt. (Built-up Area) + 30.00 sq. mt. (Common Circulation + Services)
 Carpet Area: 60.50 sq. mt.

Seivable Area: 330 sq. ft.
 330 sq. ft. (Built-up Area) + 330 sq. ft. (Common Circulation + Services)
 Carpet Area: 330 sq. ft.

- Note:**
1. The window size/position in rooms may change because of structural features.
 2. The overall layout may vary because of statutory reasons in case required.
 3. Columns location in view may vary as per structure.
 4. Layout shown is for illustration purpose, for specific unit floor plan please consult sales.
 5. Seivable area is tentative and is subject to change due to modifications asked for by approving authorities from time to time till occupancy certificate is obtained. Architect reserves the right to add/deduct any modification/alterations as required.

Isometric View



*Storage shown for illustration purpose only and is subject to change.

Type C - Typical Floor Unit

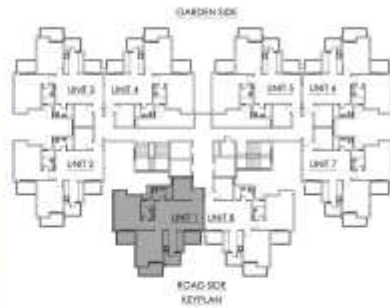

Saleable Area: 326.25 sq. mtr.
 26.65 sq. mtr. (Ducts up Area) + 29.95 sq. mtr. (Common Circulation + Services)
 Carpet Area: 300.00 sq. mtr.

Saleable Area: 305 sq. ft.
 265 sq. ft. (Ducts up Area) + 200 sq. ft. (Common Circulation + Services)
 Carpet Area: 270 sq. ft.

- Notes:**
1. The window size/its location is subject to change because of structural features.
 2. The overall layout may vary because of statutory/requirements as per required.
 3. Columns location is subject to change as per structure.
 4. Layout shown is for illustration purpose, for specific unit floor plan please contact sales.
 5. Saleable area is tentative and is subject to change due to modifications asked for by approving authorities from time to time till occupancy certificate is obtained. Architect reserves the right to add/deduct any minor specifications/alterations as required.

Isometric View



Photograph shown is for illustration purposes only and is subject to change.

